



FRONT LOAD WASHING MACHINE

Operating and installation instructions



HZH MARINE GROUP CO.,LTD.

Safety Precautions



Congratulations on your purchase of this our washing machine. These Owner's Instructions contain valuable information on the installation, use, and care of this appliance. Please take the time to read these instructions so that you can take full advantage of the washing machine's features and enjoy this appliance for many years to come.

Before using the appliance

- Packing materials can be dangerous to children; keep all packing material (plastic bags, polystyrene, etc.) well out of the reach of children.
- Make sure that water and electrical connections are made by qualified technicians, observing the manufacturer's instructions (see "Installing the Washing Machine" on page 2) and local safety regulations.
- All packaging and shipping bolts must be removed before the appliance is used. Serious damage may occur if they are not removed. See "Removing the shipping bolts" on page 3.
- Before washing clothes for the first time, you must run a complete cycle without clothes. See "Washing for the first time" on page 7.
- This product is designed for low water consumption and effective washing performance. The water level during wash and rinse cycles may be invisible in the front viewing windows. This is normal and does not indicate malfunction.
- Please dispose of the package for this product in an environmentally friendly manner.

Safety instructions

- Before cleaning or carrying out maintenance, unplug the appliance from the electrical outlet.
- Make sure that the pockets of all clothing to be washed are empty. Hard, sharp objects, such as coins, safety pins, nails, screws, or stones can cause extensive damage to the appliance.
- Always unplug the appliance and turn off the water after use.
- Before you open the door of the appliance, check that the water has drained. Do not open the door if you can still see water.
- Pets and small children may climb into the appliance. Check the appliance before each use.
- The glass door becomes very hot during the washing cycle. Keep children away from the appliance while it is in use.
- Do not attempt to repair the appliance yourself. Repairs made by inexperienced or unqualified persons may cause injury and/or make more serious repairs to the appliance necessary.
- If the plug (power supply cord) is damaged, it must be replaced by the manufacturer or its service agent or a similarly qualified person in order to avoid a hazard.
- This appliance should only be serviced by an authorized service center, and only genuine spare parts should be used.
- This appliance is not intended for use by young children or infirm persons unless they have been adequately supervised by a responsible person to ensure that they can use the appliance safely. Young children should be supervised to ensure that they do not play with the appliance.
- If this appliance is supplied from a cord extension set or an electrical portable outlet device, the cord extension set or electrical portable outlet device must be positioned so that it is not subject to splashing or ingress of moisture. Additionally, the cord extension set or electrical portable out let device must be of a current rating suitable for the appliance.

SAVE THESE INSTRUCTIONS

Safety Precautions-----	inside cover
Installing the Washing Machine-----	2
Unpacking the washing machine-----	2
Overview of the washing machine -----	2
Selecting a location -----	3
Adjusting the leveling feet -----	3
Removing the shipping bolts -----	3
Connecting the water supply hose -----	4
Positioning the drain hose -----	5
Plugging in the machine-----	6
Washing a Load of Laundry-----	7
Washing for the first time -----	7
Putting detergent in the washing machine -----	7
Overview of the control panel -----	8
Washing clothes using intelligent programs-----	10
Using delay start-----	11
Washing tips and hints-----	12
Maintaining the Washing Machine-----	13
Draining the washing machine-----	13
Cleaning the debris filter -----	13
Cleaning the detergent drawer and recess -----	14
Cleaning the exterior -----	14
Repairing a frozen washing machine -----	14
Cleaning the water hose mesh filter -----	15
Troubleshooting-----	16
Problems and solutions -----	16
Understanding error messages -----	16
Cautions of Duvet course -----	17
Appendix-----	18
Wiring Diagram-----	20
Warranty Card-----	21

Installing the Washing Machine

Unpacking the Washing Machine

Unpack your washing machine and inspect it for shipping damage. Also make sure that you have received all of the items shown below. If the washing machine was damaged during shipping or you do not have all of the items, contact your dealer immediately.

Overview of the washing machine

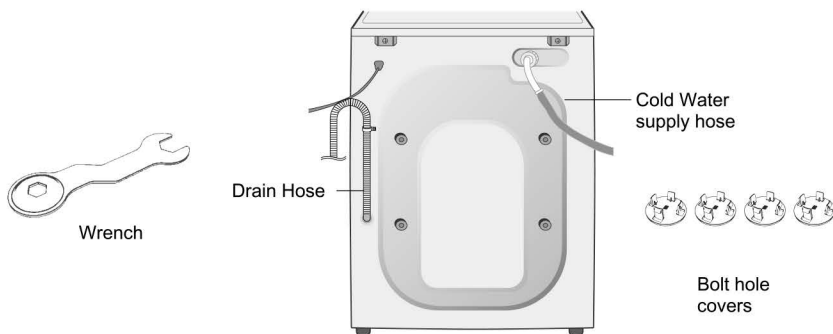
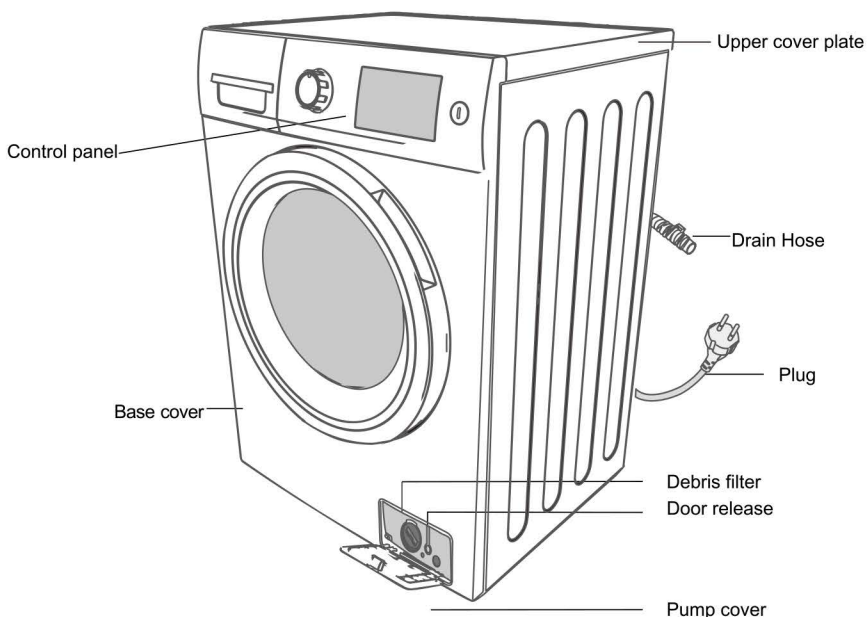

Selecting a location

Before you install the washing machine, select a location with the following characteristics:

- A hard, level surface (if the surface is uneven, see "Adjusting the leveling feet," below)
- Away from direct sunlight.
- Adequate ventilation
- Room temperature that will not fall below 0°C
- Away from sources of heat such as coal or gas

Make sure that the washing machine does not stand on its power cord.

Ventilation openings must not be obstructed by carpeting when the washing machine is installed on a carpeted floor.

Adjusting the leveling feet

If the floor is uneven, adjust the feet (do not insert pieces of wood or any other objects under the feet):

1. Loosen the leg bolt by turning it with your hand until it is at the desired height.
2. Tighten the locking nut by turning it with the supplied wrench.

If the washer is placed on an uneven or weak surface, noise or vibration occurs.

(Only 1 degree angle is allowed.)

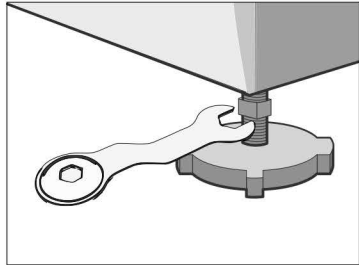

Removing the shipping bolts

Before using the washing machine, you must remove the four shipping bolts from the back of the unit. To remove the bolts:

1. Loosen all bolts with the supplied wrench before removing them.
2. Take each bolt head and pull it through the hole.
Repeat for each bolt.
3. Fill the holes with the supplied plastic covers.
4. Keep the shipping bolts for future use.

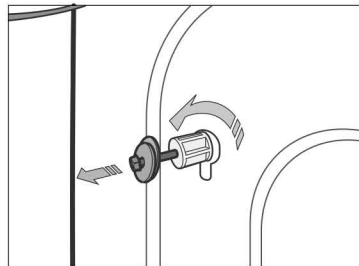

Connecting the water supply hose

The water supply hose must be connected to the washing machine at one end and to the water faucet at the other. Do not stretch the water supply hose. If the hose is too short replace the hose with a longer, high pressure hose.

To connect the water supply hose:

1. Take the L-shaped arm fitting for the cold water supply hose and connect to the cold water supply intake on the back of the machine. Tighten by hand.
2. Connect the other end of the cold water supply hose to your sink's cold water faucet and tighten it by hand. If necessary, you can reposition the water supply hose at the washing machine end by loosening the fitting, rotating the hose, and retightening the fitting.

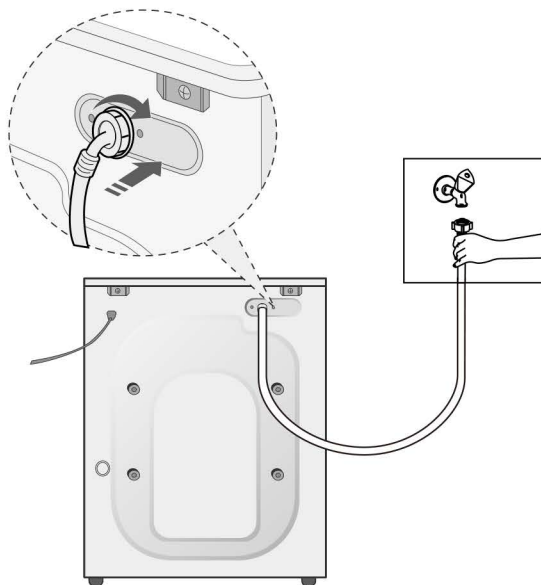

NOTICE The appliance is to be connected to the water mains using new hose-sets and that old hosesets should not be used.

NOTICE After completing connection, if water leaks from the hose, then repeat the same steps. Use the most conventional type of faucet for water supply. In case the faucet is square or too big, remove the spacing ring before inserting the faucet into the adaptor.



CAUTION



Do not bend or pull the water drainage hose.

Positioning the drain hose

The end of the drain hose may be positioned in these ways:

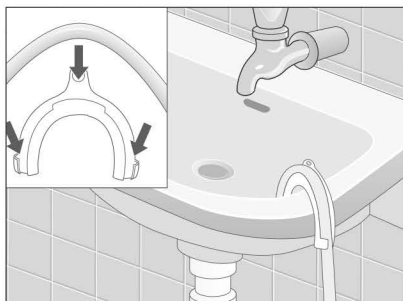

Over the edge of a wash basin.

The drain hose must be placed at a height not more than 90 cm. To keep the drain hose spout bent, use the supplied plastic hose guide. Secure the guide to the wall with a hook or to the faucet with a piece of string to prevent the drain hose from moving.

In a sink drain pipe branch

The drain pipe branch must be above the sink siphon so that the end of the hose is at least 60 cm above the ground.

In a drain pipe

We recommends that you use a 60 cm high vertical pipe; it must be no longer than 90cm.

Plugging in the machine

For European Users. You will **NOT** need to ground the plug of the washing machine.

For U.S. Users. You **MUST** ground the plug of the washing machine.

Check with a licensed electrician before using the machine to make sure it is properly grounded.

For U.K. Users.

Wiring Instructions

WARNING THIS APPLIANCE MUST BE EARTHED.

This appliance must be earthed. In the event of an electrical short circuit, earthing reduces the risk of electric shock providing an escape wire for the electric current.

The appliance is equipped with a mains lead which includes an earth wire for connecting to the earth terminal of your mains plug.

The plug must be plugged into a socket that is properly installed and earthed.

*The wires in this mains lead are coloured in accordance with the following code:

- Green and yellow : Earth
- Blue : Neutral
- Brown : Live

- AS the colours of the wires in the mains lead of this appliance may not correspond with the coloured markings identifying the terminals in your plug, proceed as follows.

- Connect the green and yellow wire to the terminal in the plug marked with the letter E or the earth symbol (\equiv) or coloured green or green-and-yellow.
- Connect the blue wire to the terminal marked with the letter N or coloured black.
- Connect the brown wire to the terminal marked with the letter L or coloured red.

- * Consult a qualified electrician or service technician if in doubt about any of these instructions.

The manufacturer of this washing machine will not accept any liability for damage to persons or material for non observance of these requirements. There are no user serviceable parts inside the washing machine and if the mains lead of this appliance is damaged, it must only be replaced by qualified service personnel approved by the manufacturer because special tools are required.

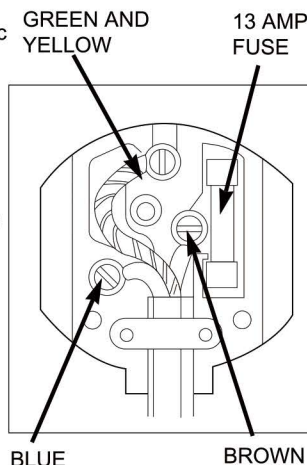

WARNING

Ensure that the plug and power cord are not damaged before use. If you have any reason to remove the moulded plug from this appliance, immediately remove the fuse and dispose of the plug. Do not connect the plug to a mains socket under any circumstances as there is a danger of electric shock.

CIRCUITS

Your washing machine should be operated on a separate circuit from other appliances. Failure to do this may cause the circuit breaker to trip or the fuse to blow.

Washing for the first time

Before washing clothes for the first time, you must run a complete cycle without clothes. To do this:

1. Press the Power button until the Display on.
2. Pour a little detergent into compartment ① in the detergent drawer.
3. Turn on the water supply to the washing machine.
4. Select **Drum Clean** program.
5. Press the Start/Pause button.
 - This will remove any water from the manufacturer test run remaining in the machine.

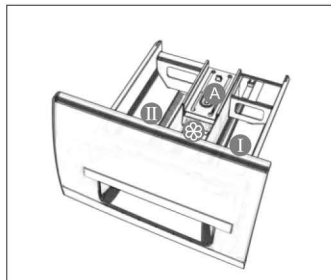

Dispenser ① : Detergent for prewash or starch.

Dispenser ② : Detergent for main wash, water softener, pre-soaking agent, bleach and stain removal product.

Dispenser ③ : Additives, e.g. fabric softener or former (fill no higher than lower edge of insert "A")

Putting detergent in the washing machine

1. Pull out the detergent drawer.
2. Add laundry detergent into compartment ② .
3. Add softener into compartment ③ (if you desire).
4. Add prewash detergent into compartment ① (if you desire).

Caution :

Concentrated or thick fabric softener and conditioner must be diluted with a little water before being poured into the dispenser (prevents the overflow from becoming blocked.)

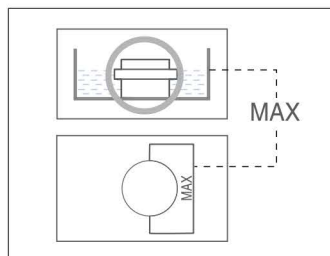

Overview of the control panel

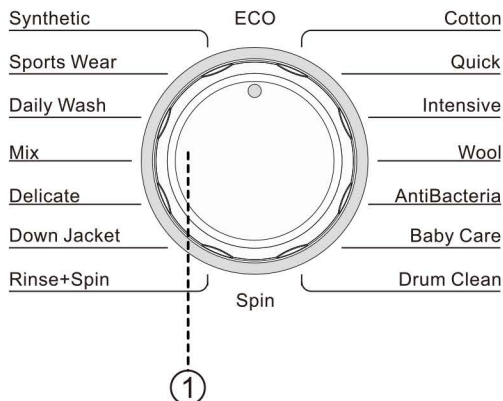

1.Washing machine program selector

Select the appropriate cycle for the type of load. The knob can be rotated positive and reverse.

There was 16 available wash programs.

ECO,Cotton, Quick,Intensive, Wool, Antibacteria,Baby Care,Drum Clean,Spin
Rinse+Spin, Down Jacket, Delicate, Mix,Daily Wash,Sport Wear,Synthetic

2.Display panel

Displays the remaining wash cycle time, all of washing information and error messages.

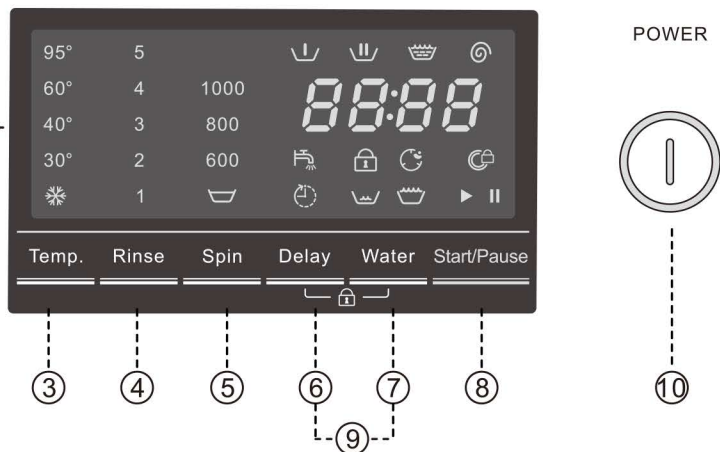

3. Temperature selection button

Press the button repeatedly to cycle through the available water temperature options.

4. Rinse selection button

Press the rinse button to add rinse cycles. Maximum number of rinse cycles is five.

5. Spin selection button



Press the button repeatedly to cycle through the available spin speed options.

6. Delay time button

Press the button to set delay time. Press once to add a hour, The minimum delay time is 3 hours, after the delay time is set, press the start button to start the countdown.

7. Water-level selection button

Press the button repeatedly to select the level of water.

There are normal(no display), high () and low() three modes.

8. Start/Pause button

Press the button to start or pause the program.

9. Child Lock combination button

Press **Delay** and **Water** buttons at the same time for 3 seconds to set/reset the Child Lock.

10. Power button

Press once to turn the washing machine on, press again to turn the washing machine off.

If the washing machine power is left on for longer than 1 minute without any buttons being touched, the power automatically turns off.

Washing clothes using Intelligent washing machine

Your new washing machine makes washing clothes easy, using our “Intelligent” automatic control system. When you select a wash program, the machine will set the correct temperature, washing time, and washing speed.

To wash clothes using the Intelligent programs:

1. Turn on your sink's water faucet.
2. Press the **POWER** button.
3. Open the door.
4. Load the articles one at a time loosely into the drum, without overfilling.
5. Close the door.
6. Add the detergent, softener, and pre-wash detergent (if necessary) into the appropriate compartment.

Note: Pre-wash is only available when choosing the “Intensive” program.
It is only necessary if your clothing is heavily soiled.

7. Turn the program selector to select the appropriate program for the type of your laundry.
8. At this time, you can select the wash temperature, rinsing times, spin speed, delay time by pressing the appropriate option button.
9. Press the **Start/Pause** button on the touch screen and the wash cycle will begin.
The process indicator will light up and the remaining time for the cycle will appear in the display.

Pause Option

1. During wash program is running, it is possible to add/remove laundry items to the load.
2. By depressing the **Start/Pause** button, the door is unlocked.
3. The door can NOT be opened when the water is too HOT or the water level is too HIGH.
4. After closing the door, depressing the **Start/Pause** button again will restart the washing process.

When the cycle is finished:

After the total cycle has finished, the power will turn off automatically.

1. Open the door.
2. Remove laundry.

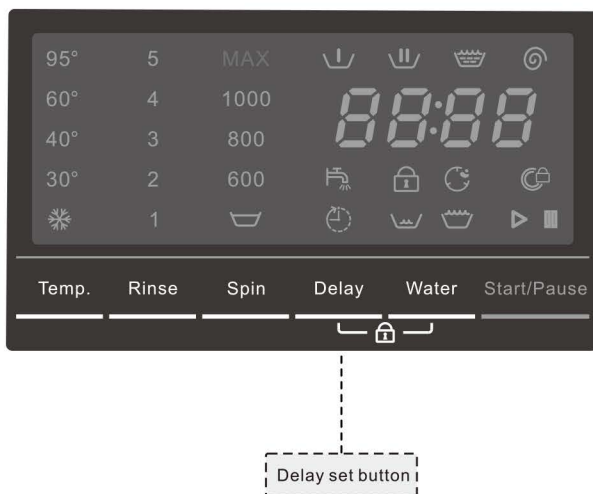

Using Delay Start

You can set the washing machine to finish your wash automatically at a later time, choosing from 3 to 24 hour delay (in 1 hour increments). Displayed hours means the time of finished washing-cycle.

To do this:

1. Manually or automatically set your washing machine for the type of clothes you are washing.
2. Press the **Delay** button repeatedly until the delay time is set.
3. Press the **Start/Pause** button. The Delay Start indicator will light, and the clock will begin counting down until it reaches your finish time.
4. To cancel Delay Start, press the **POWER** button, then turn the washing machine on again.

Washing tips and hints

Sorting your laundry : Sort your laundry according to the following characteristics:

- Type of fabric care label symbol : Sort laundry into cottons, mixed fibers, synthetics, silks, wools and rayon.
- Colour :Divide whites and colours. Wash new, coloured items separately.
- Size: Placing items of different sizes in the same load will improve the washing action.
- Sensitivity: Wash delicate items separately, using the Delicate wash program for pure new wool, curtains and silk articles. Check the labels on the items you are washing or refer to the fabric care chart in the appendix.

Emptying pockets : Coins, safety pins and similar items can damage linen, the washing machine drum, and the water tank.

Securing fasteners : Close zippers and fasten buttons or hooks; loose belts or ribbons should be tied together.

Prewashing cotton : Your new washing machine, combined with modern detergents, will give perfect washing results, thus saving energy, time, water and detergent. However, if your cotton is particularly dirty, use a prewash with a protein-based detergent.

Determining load capacity: Do not overload the washing machine or your laundry may not wash properly. Use the chart below to determine the load capacity for the type of laundry you are washing.

Fabric Type	Load Capacity
Cotton	8.0 kg
Synthetic	4.0 kg
Quick	3.5 kg
Delicate	2.5 kg
Wool	2.0 kg
Intensive	5.0 kg
Down Jacket	2.0kg

Detergent tips: The type of detergent you should use is based on the type of fabric (cotton, synthetic, delicate items, wool), colour, wash temperature, degree and type of soiling. Always use "low suds" laundry soap, which is designed for automatic washing machines.

Follow the detergent manufacturer's recommendations based upon the weight of the laundry, the degree of soiling, and the hardness of the water in your area. If you do not know how hard your water is, ask your water authority.

Note:

Keep detergents and additives in a safe, dry place out of the reach of children.

Draining the washing machine

Cleaning the debris filter

This is necessary if the water cannot be completely drained. The pump is blocked by either loose debris or fluff which accumulates if fluff-giving fabrics are washed at high temperature.

Clean the debris filter 5 or 6 times a year, or when you see the following message  on the display screen.

1. Unplug the washing machine from the power supply.
2. Fold down the pump cover.

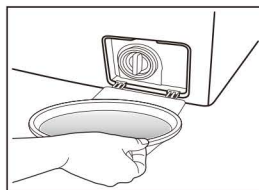
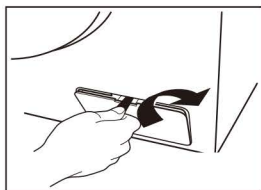

3. Place a shallow container under the pump cover (outlet filter). Loosen filter cap without removing it completely to allow the water to empty gradually. Close the filter cap when the container is full. Repeat the operation until all the water has been emptied. Use a suitable container to remove any remaining water which may fill on the floor.
4. Loosen the filter cap completely.
5. Remove any loose debris/fluff from inside the pump and clean the pump. The pump impeller must be able to rotate.
Clean any residual suds or fluff from the thread of the filter cap and pump housing.
6. Attach and tighten the filter cap.
7. Close the pump cover plate.

Cleaning the detergent drawer and recess

1. Press the release lever on the inside of the detergent drawer and pull it out.
2. Wash all of the parts under running water.
3. Clean the drawer recess with an old toothbrush.
4. Push the drawer back into place.
5. Run a rinse program without any laundry in the drum.

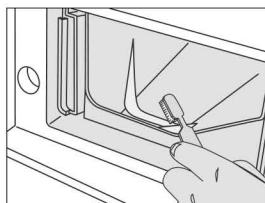
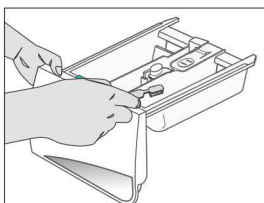
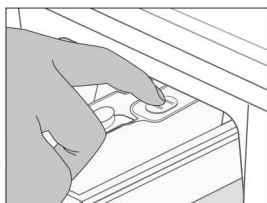

Cleaning the exterior

1. Wipe the washing machine surfaces, including the control panel, with a soft cloth and non-abrasive household detergents.
2. Use a soft cloth to dry the surfaces.
3. Do not pour water on the washing machine.

Repairing a frozen washing machine

If the temperature drops below freezing and your washing machine is frozen:

1. Unplug the washing machine.
2. Pour warm water on the source faucet to loosen the water supply hose.
3. Remove the water supply hose and soak it in warm water.
4. Pour warm water into the washing machine drum and let it sit for 10 minutes.
5. Reconnect the water supply hose to the water faucet and check if the water supply and drain operations are normal.

Cleaning the water hose mesh filter

You should clean the water hose mesh filter at least one time per year, or when you see the following error message on the display:

To do this:

1. Turn off the water source to the washing machine.
2. Unscrew the hose from the back of the washing machine.
3. Clean the inside and outside of the threaded connector.
4. Screw the hose back onto the washing machine.
5. Turn on the faucet and make sure the connections are watertight.

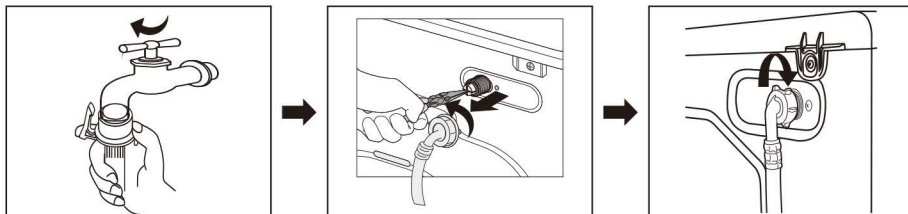

Problems and solutions

The washing machine will not start

- Make sure the door is firmly closed.
- Make sure the washing machine is plugged in.
- Make sure the water source faucet is turned on.
- Make sure to press the Start/Pause button.

No water or insufficient water supply

- Make sure the water source faucet is turned on.
- Make sure the water source hose is not frozen.
- Make sure the water intake hose is not bent.
- Make sure the filter on the water intake hose is not clogged.

Detergent remains in the detergent drawer after the wash program is complete

- Make sure the washing machine is running with sufficient water pressure.
- Put the detergents in the inner parts of the detergent drawer(away from the outside edges).

Washing machine vibrates or is too noisy

- Make sure the washing machine is set on a level surface. If the surface is not level, adjust the washing machine feet to level the appliance (see page 3).
- Make sure that the shipping bolts are removed (see page 3).
- Make sure the washing machine is not touching any other object.
- Make sure the laundry load is balanced.

The washing machine does not drain and/or spin

- Make sure the drain hose is not squashed or bent.
- Make sure the debris filter is not clogged (see page 13).

The Door does not open

1. Disconnect the power plug from the power supply.
2. Remove the water from the washing machine.
3. Open the pump cover.(see page 13)
4. Locate the plastic lock release tab and pull down to open the door.

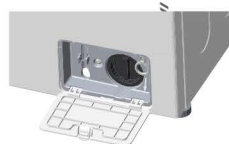

Understanding error messages

Error displayed

Solution

E01

- Close the door and check the lock of the door.

E02

- Make sure the source water faucet is turned on.
- Check the water pressure.

E03

- Clean the debris filter.
- Make sure the drainage hose is installed correctly.

Ub

- The laundry was not spun; .
- Few laundry or large items of laundry tangled and could not be distributed evenly in the drum.

Other code

- Call after-sales service.

Before contacting After-Sales service:

1. Try to remedy the problem (See "Troubleshooting" on this page).
2. Restart the programme to see if the fault is repeated.
3. If the malfunction persists, call after-sales service and describe the problem.

Caution: When using the Duvet course

Use of Detergents in Duvet Course

When washing larger volume laundry items, including duvet, do not put the following detergents directly into the drum:

- . Tablet and capsule type detergents



- . Detergents using ball and net.

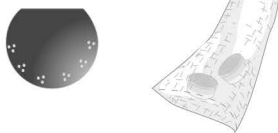

Detergents not fully dissolved may bring about imperfect washing.

For effective washing, add detergent into the detergent drawer.

Do not wash a duvet by spreading detergent directly on it.





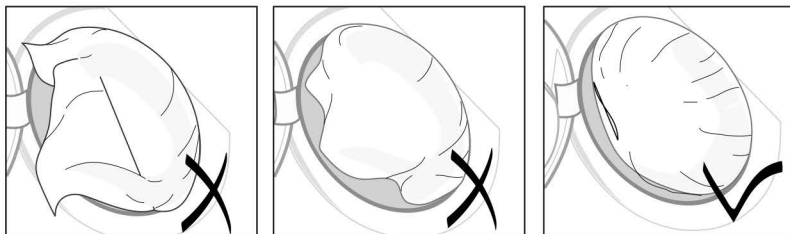























Cautions in Putting Duvet in the Drum

1. Do not use unnecessary force or too large Duvet.
2. Make sure that a corner or folded part of the duvet directs inwards.



Picture of Being Put Properly

Fabric care chart

	Resistant material		Can be ironed at 100°C max
	Delicate fabric		Do not iron
 	Item may be washed at 95°C		Can be dry cleaned using any solvent
 	Item may be washed at 60°C		Dry clean with perchloride, lighter fuel, pure alcohol or R113 only
 	Item may be washed at 40°C		Dry clean with aviation fuel, pure alcohol or R113 only
 	Item may be washed at 30°C		Do not dry clean
	Item may be hand washed		Dry flat
	Dry clean only		Can be hung to dry
	Can be bleached in cold water		Dry on clothes hanger
	Do not bleach		Tumble dry, normal heat
	Can be ironed at 200 °C max		Tumble dry, reduced heat
	Can be ironed at 150 °C max		Do not tumble dry

Electrical warnings

To reduce the risk of fire, electrical shock, and other injuries, keep these safety precautions in mind:

- Operate the appliance only from the type of power source indicated on the marking label. If you are not sure of the type of power supplied to your home, consult your appliance dealer or local power company.
- In order to ensure your safety, you must plug the cable into a socket which connected to earth. And please check your socket to make sure that it is connected with reliable earth correctly.
- Power supply cords should be routed so that they are unlikely to be walked on or pinched by items placed on or against them. Pay particular attention to cords at plugs, convenience receptacles, and the point where they exit from the unit.
- Do not overload the wall outlet or extension cords. Overloading can result in fire or electric shock.

Protecting the environment

- This appliance is manufactured from recyclable materials. If you decide to dispose of this appliance, please observe local waste disposal regulations. Cut off the power cord so that the appliance cannot be connected to a power source. Remove the door so that animals and small children cannot get trapped inside the appliance.
- Do not exceed the detergent quantities recommended in the detergent manufacturers' instructions.
- Use stain removal products and bleaches before the wash cycle only when strictly necessary.
- Save water and electricity by only washing full loads (the exact amount depends upon the program used).

Specification

Model	OCF911D	OCF922D
Rated Capacity	9.0kg	9.0kg
Rated Voltage/Frequency	110V 60Hz	220V 50-60Hz
Rated Power Input	1950W	1950W
Heating Power	1800W	1800W
Wash Power	150W	150W
Spin Power	500W	500W
Water Pressure	0.05-1MPa	0.05-1MPa
Water Proof	IPX4	IPX4
Product Dim	596*545*850mm	596*545*850mm
Net Weight	60kg	60kg

Wiring Diagram

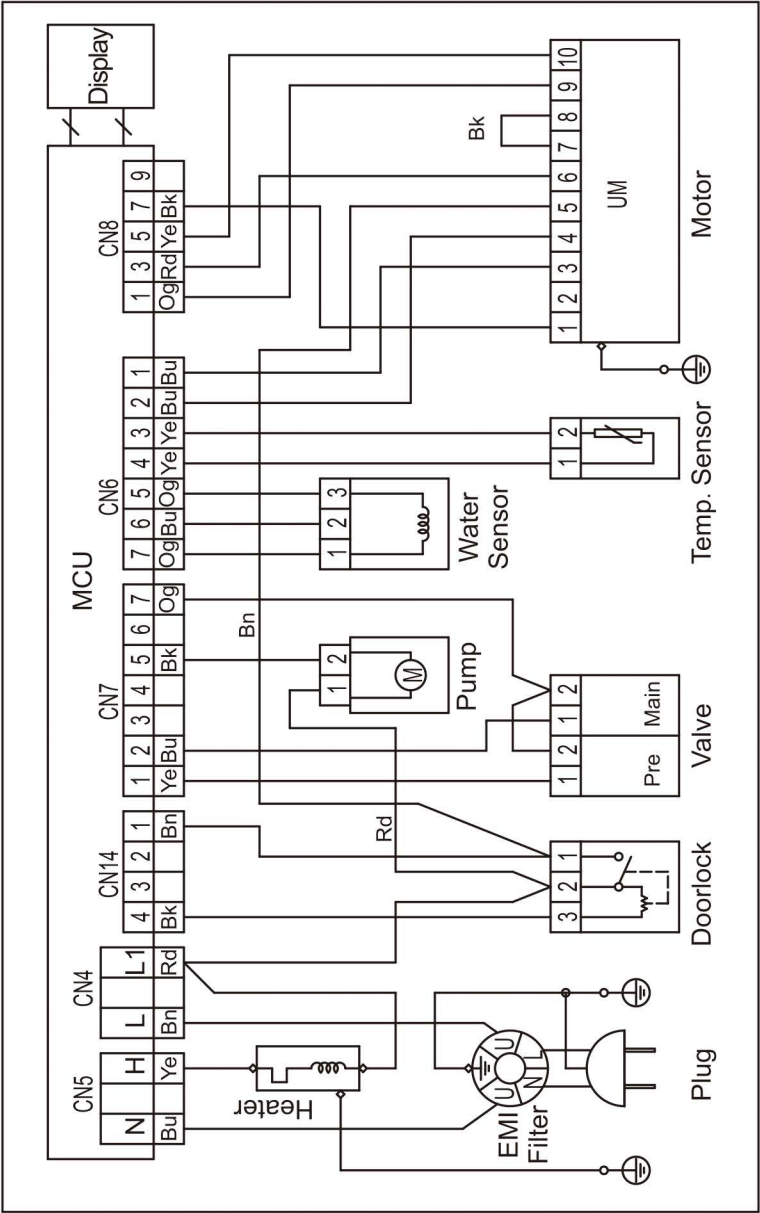

Warranty Card

Model Number	<input type="text"/>
Serial Number	<input type="text"/>
Purchase Store	<input type="text"/>
Purchase Time	<input type="text"/>
Customer Name	<input type="text"/>
Customer Phone	<input type="text"/>
Customer Add.	<input type="text"/>
Repair Times	<input type="text"/>

NOTICE

Maintain won't be given under the following circumstance

1. Without Protection to fix warrantees.
2. The breakdown caused by the manipulation that hasn't follow the requests of the Manual.
3. The damage caused by the dismantle movement of a non-our-company authorized maintainer.
4. The breakdown, row harm or damaged because of the move or drop.
5. The damage caused by customer inappropriate preservation, maintain, or the usage.
6. Easy damaged pieces and present accessories are not concerned.
7. The breakdown and the damage caused by the Force majeure.

HZH MARINE GROUP CO.,LTD.

Add : No.268 Maogang Road Huangpu Guangzhou China

Tel : +86 20 82369196 / +86 138 26486745

E-mail : info@hzhmarine.com **Web :** www.hzhmarine.com

Contents of this brochure could be changed without written notice.